

The MOTOMAN-MH6 is a compact and powerful 6-axis robot with high performance in a variety of applications such as machine tending, material handling and processing, where versatility is required.

Its slim and lightweight design enables it to be positioned close to the work-piece to improve part accessibility. With increased speed of the robot axes, cycle times can be reduced up to 15% for increased productivity.



**NEW GENERATION!
DX100**

Key benefits

- Compact and powerful
- Cycle time reduction with up to 15%
- Ideal for a variety of applications, multi-purpose robot
- Wide working envelope

MOTOMAN-MH6

General purpose and handling

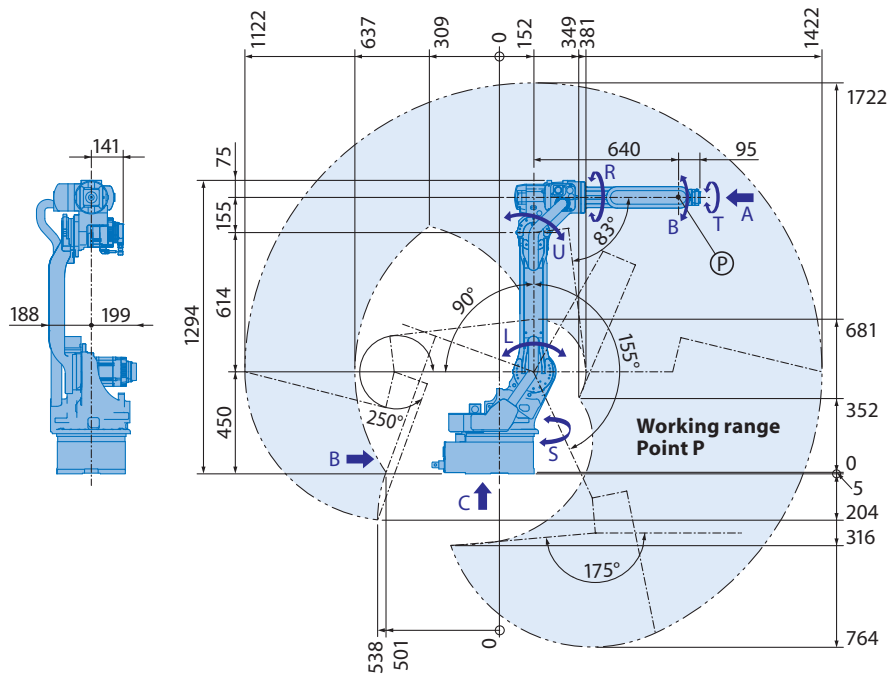

View A

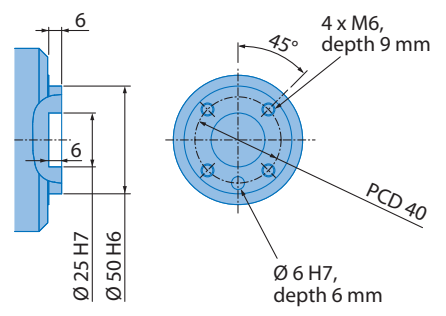

View B

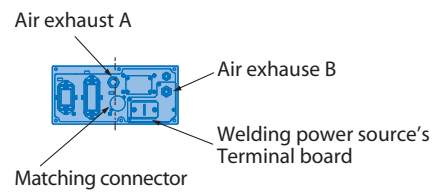

View C

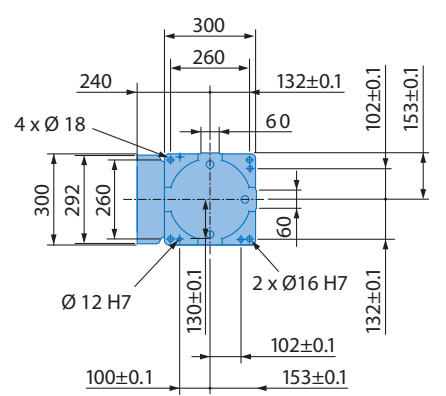

Mounting options: Floor, ceiling, wall

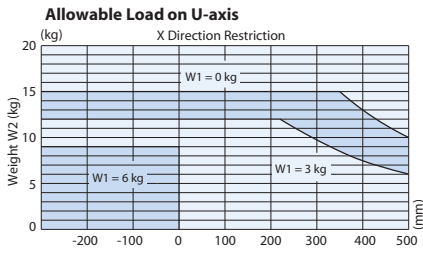
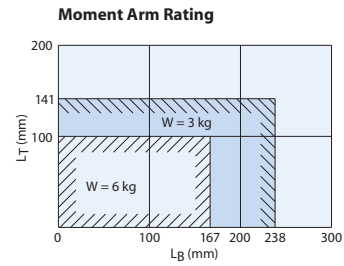
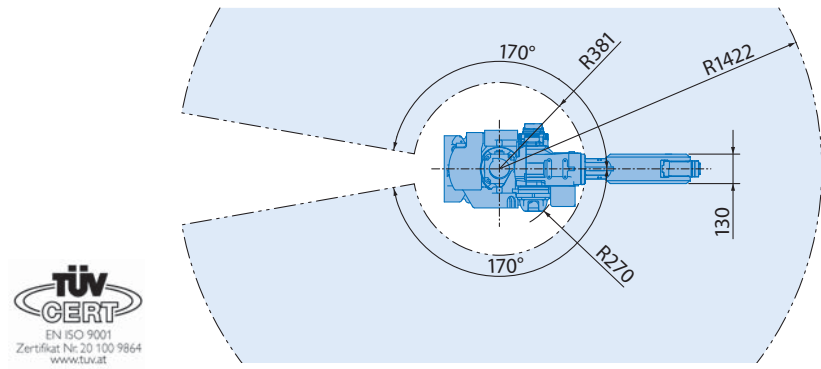

Distance between Center of U-axis Rotation and Load Gravity

All dimensions in mm | Technical data may be subject to change without previous notice | Please request detailed drawings at info@motoman.de – MH6, B-07-2009

Specifications MH6

Axes	Maximum motion range [°]	Maximum speed [°/sec.]	Allowable moment [Nm]	Allowable moment of inertia [kg x m ²]	Controlled axes	6
S	±170	220	-	-	Max. payload [kg]	6
L	+155/-90	200	-	-	Repet. pos. accuracy [mm]	±0.08
U	+250/-175	220	-	-	Max. working range [mm]	R = 1422
R	±180	410	11.8	0.27	Temperature [°C]	0 to +45
B	+225/-45	410	9.8	0.27	Humidity [%]	20 – 80
T	±360	610	5.9	0.06	Weight [kg]	130
					Power supply, average [KVA]	1.5



Headquarters
Kammerfeldstraße 1
D-85391 Allershausen
Fon 0049-81 66-90-0
Fax 0049-81 66-90-103
info@motoman.de
www.motoman.eu

Training centre and sales office Frankfurt
Hauptstraße 185
D-65760 Eschborn
Fon 0049-61 96-777 25-0
Fax 0049-61 96-777 25-39
info@motoman.de
www.motoman.eu